



Chapel Street, Pontnewydd, Cwmbran

£600 pcm

One bedroom, first floor flat in the heart of Pontnewydd, close to local transport links and amenities. Comprising of Living room, kitchen, bathroom and bedroom.

Double Glazing | Fitted Bathroom | Fitted Kitchen |

01495236989

info@smartletwales.co.uk

One bedroom first floor apartment

Council Tax Band: A (Torfaen)

Deposit: £600

Holding Deposit: £138.46

Kitchen

w: 2m x l: 3.32m (w: 6' 7" x l: 10' 11")

Smooth plastered walls and ceiling, vinyl flooring, radiator.

Hall

w: 1.55m x l: 3.82m (w: 5' 1" x l: 12' 6")

Smooth plastered walls and ceiling, carpet.

Lounge

w: 4.73m x l: 3.35m (w: 15' 6" x l: 11')

Smooth plastered walls and ceiling, carpet, 2 double glazed windows to front, radiator.

Bedroom 1

w: 3.07m x l: 5.65m (w: 10' 1" x l: 18' 6")

Smooth plastered walls and ceiling, carpet, radiator, window to side

Bathroom

w: 2.29m x l: 1.66m (w: 7' 6" x l: 5' 5")

Please note

No pets, no smokers, must be full time employed.

Holding fee of one weeks rent

The holding deposit will be non-refundable should a tenant choose not to enter an occupation contract or fail to take reasonable steps to enter a contract.

On completion of an occupation contract the holding deposit amount will be deducted from the first months rent payment.
Bond £600.00

COUNCIL TAX BAND = A



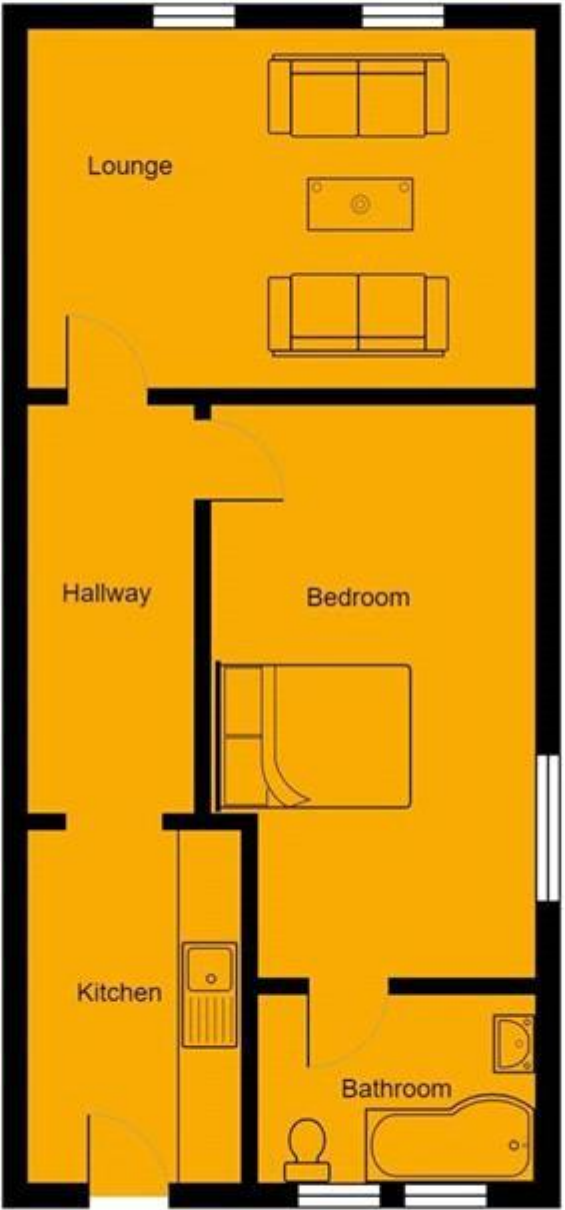

Energy Efficiency Rating		
	Current	Potential
Very energy efficient - lower running costs		
(92-100) A		
(81-91) B		
(69-80) C		
(55-68) D	66	73
(39-54) E		
(21-38) F		
(1-20) G		
Not energy efficient - higher running costs		
England & Wales		EU Directive 2002/91/EC

Whilst every effort is made to ensure the accuracy of these details, it should be noted that the measurements are approximate only. Floorplans are for representation purposes only and prepared according to the RICS Code of Measuring Practice by our floorplan provider. Therefore, the layout of doors, windows and rooms are approximate and should be regarded as such by any prospective tenant.